

### Entrance Level

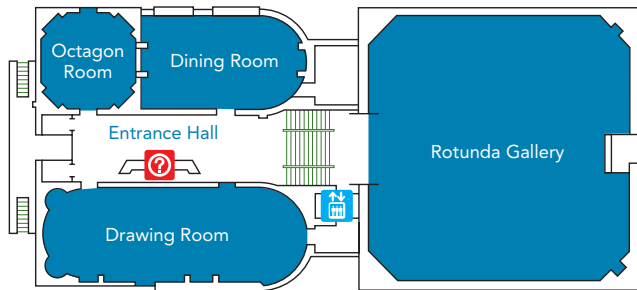

### Lower Level

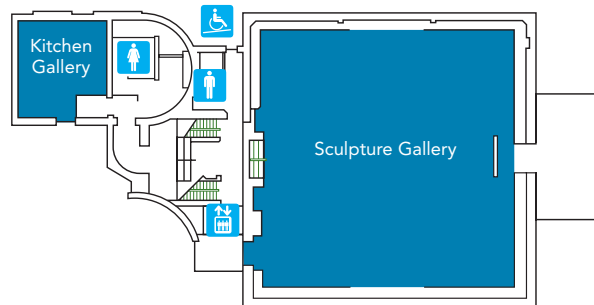

### Upper Level

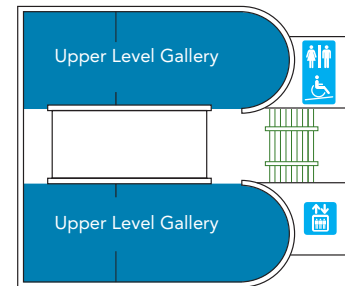

Elevators



Wheelchair Ramp



Ladies' Restrooms



Men's Restrooms



Wheelchair Accessible Restrooms



Information Desk/Admission

## ENTRANCE LEVEL

### Drawing Room

Now used as a gallery for displaying fine and decorative art from temporary exhibitions, the Drawing Room originally served as an area for public receptions and entertaining, prefacing the modern living room.

### Octagon Room

The Octagon Room, drawing its current name from its unusual 8-sided shape, was originally a receiving room and study, and later an intimate sitting room. One of the Telfair Academy's two 19th-century period rooms, today it houses decorative arts dating from the early 1800s when the building was home to Alexander Telfair.

### Dining Room

Housing various Telfair family items from the museum's decorative arts collection, this elegant period room features a reproduction of a popular 19th-century wallpaper pattern, the *Monuments of Paris*.

### Rotunda Gallery

The Rotunda, designed as the museum's main gallery by first director Carl Brandt and architect Detlef Lienau, houses 19th- and 20th-century works from the museum's permanent collection.

## LOWER LEVEL

### Sculpture Gallery

The Sculpture Gallery was originally conceived as the museum's "cast room," housing over 70 plaster-cast replicas of classical Greek and Roman sculpture. Today, six of the casts remain on view in the gallery, along with selections of 19th- and 20th-century art from the Telfair's permanent collection.

### Kitchen Gallery

The Kitchen Gallery, located in one of the two original kitchens of the Telfair mansion, includes many features of an early 19th-century kitchen, such as an original hearth, double oven, and built-in shelving.

## UPPER LEVEL

### Upper Level Galleries

Formerly serving as bedrooms, these spaces were renovated in the 1880s and now serve as temporary exhibition galleries for both Telfair-organized and traveling shows.